



Semiconductor (AC) fuses

American Round Fuses Form 101 Range A70Q



Semiconductor Protection Fuses

A70Q Amp-trap® Semiconductor Protection fuses were developed for inverter applications requiring extremely low I²t. A70Q fuses provide the most responsive protection for applications not required to sustain heavy overloads.

Features/Benefits

- Lowest I²t of any fuse in this voltage rating for best overall protection
- 700V AC, 650V DC rating allows protection of greater variety of circuits
- Solid fill technology for extra reliability in performance

Ratings

- AC: 35-600A
700VAC, 100kA I.R.
- DC: 35-600A
650VDC, 100kA I.R.
L/R = 10ms

Approvals

- UL Recognized Component
- AC: GuideNo.JFHR2
- DC: Tested to UL Standard 198L Parameters (35-600A)

Highlights

- Extremely Fast Acting
- Current Limiting
- Lowest I²t

Applications

- Protection of inverters and other equipment requiring the best AC or DC protection in this voltage range



Single Pole Fuse Blocks for A70Q Fuses

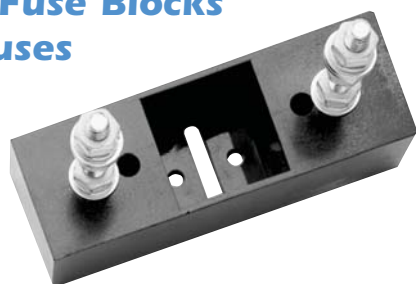

Fuse Ampere Rating	Fuse block	
	Catalog Number	Reference Number
35-100	P243C	M219040
125-400	P266A	Y212380
450-600	P266F	S213410

Catalog Numbering System

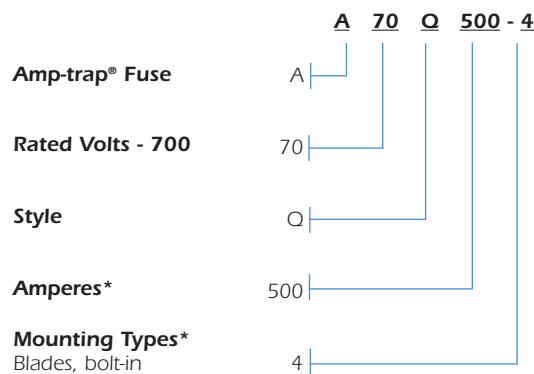

* For ampere ratings and types not listed, ask sales agent.



American Round Fuses Form 101 Range A70Q



Semiconductor Protection Fuses

Standard Fuse Ampere Ratings

Ampere Rating	Catalog Number	Reference Number
35	A70Q35-4	D214846
40	A70Q40-4	T216884
50	A70Q50-4	N218949
60	A70Q60-4	W219991
70	A70Q70-4	R202714
80	A70Q80-4	K211264
90	A70Q90-4	V211779
100	A70Q100-4	Y218429
125	A70Q125-4	D219469
150	A70Q150-4	H200981
175	A70Q175-4	Y202697
200	A70Q200-4	T211778
250	A70Q250-4	S212812
300	A70Q300-4	V213826
350	A70Q350-4	E215353
400	A70Q400-4	K217405
450	A70Q450-4	S217918
500	A70Q500-4	E219470
600	A70Q600-4	M222674

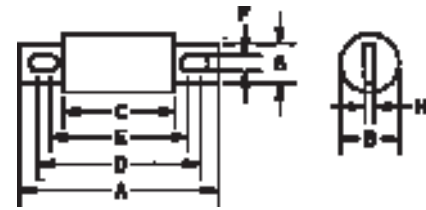

Figure 1

For ampere ratings and styles not listed, call Technical Services.

Dimensions

Catalog Number	Mounting Type	Dimensions - Inches (mm)							
			A	B	C	D	E	F	G
A70Q35 to 60	4	4.37	1.22	1.96	3.69	2.91	.34	1.00	.19
		(111)	(31.0)	(49.8)	(93.7)	(73.9)	(8.6)	(25.4)	(4.8)
A70Q70 to 100	4	4.37	1.22	1.96	3.69	2.91	.41	1.00	.19
		(111)	(31.0)	(49.8)	(93.7)	(73.9)	(10.4)	(25.4)	(4.8)
A70Q125 to 200	4	5.09	1.50	1.96	4.16	2.91	.41	1.00	.25
		(129)	(38.1)	(49.8)	(106)	(73.9)	(10.4)	(25.4)	(6.4)
A70Q250 to 400	4	5.09	2.00	1.96	4.00	2.94	.56	1.50	.25
		(129)	(50.8)	(49.8)	(102)	(74.7)	(14.2)	(38.1)	(6.4)
A70Q450 to 600	4	7.09	2.50	1.96	5.72	3.25	.56	2.00	.38
		(180)	(63.5)	(49.8)	(145)	(82.6)	(14.2)	(50.8)	(9.7)